

NOTE:
 Garages, Decks, Railings, Exterior Stairs are all optional for all homes.
 Window Shutters - Optional on all Homes
 Overhead Doors - Not Available from CSI
 Window Grills - Optional
 Kneewall Window & Siding Packages are optional (Split Level, Tri Level)
 All kneewall framing & sheathing by GC
 Gable End Overhangs - Optional on all Style Homes

Ridge
324 9/16"

Finish Ceiling
197 7/16"

8'0 1/2"

Finish Floor
181 5/16"

10'0 1/2"

9'0 1/2"

Finish Floor
Top of 2nd 00"



Front Elevation
Scale: 3/16" = 1'0"



Left Elevation
Scale: 3/32" = 1'0"



Rear Elevation
Scale: 3/32" = 1'0"



Right Elevation
Scale: 3/32" = 1'0"

Preliminary Plan
Not for Construction use

Note: These plans represent the closest approximation to the submitted design allowing for established building codes, safety standards and design limitations.
 Please make all revisions to plans in RED pen or pencil and sign and date each page. Then return to CSI for corrections.
 If no revisions are desired, sign and date each page (signifying Final Approval) & Return to CSI

SIDING SCHEDULE

SIDING	EXPO/TYPE	CORNERS	TRIM	REMARKS
VINYL	8" HOR (4" DBL)	VINYL	VINYL/PINE	(STD)
*CEDAR	SHINGLES 5" EXP	PINE BDS	PINE/HRDBD	(OPT.)
*CEDAR	CLAPBDS 4 1/2 EXP	PINE BDS	PINE/HRDBD	(OPT.)
*FIR	T-11 VERTICAL	PINE BDS	PINE/HRDBD	REQUIRES DRIP CAP (OPT)

*WOOD SIDINGS REQUIRE FIELD SEALING OR STAINING

NOTES

- REFER TO INDEX SHEET TO LOCATE SPECIFIC INFO NOT COVERED ON THIS SHEET.
 - ELEVATIONS AS REPRESENTED MAY NOT BE SPECIFIC TO MODEL OR SPECIFICATION GRADE ORDERED.
 - THE FOLLOWING ITEMS TO BE SUPPLIED BY FIELD CONTRACTOR AND ARE SUBJECT TO LOCAL INSPECTION:
 - EXCAVATION, FOUNDATION WORK, SILL PLATE, LALLY COLUMNS AND SILL SEAL.
 - EXTERIOR STAIRS WITH MAX. RISE OF 7 1/2" AND MIN. TREAD OF 11" (NOSE TO NOSE)
 - EXTERIOR RAILINGS WHERE REQUIRED.
 - DOWNSPOUTS AND GUTTERS WHERE REQUIRED.
 - THE FOLLOWING ITEMS ARE SUPPLIED BY CUSTOMIZED STRUCTURES INC. AND INSTALLED BY FIELD CONTRACTOR (SUBJECT TO LOCAL INSPECTION)
 - BALANCE OF SIDING NOT INSTALLED AT FACTORY. (NORMALLY ALL GABLE END SIDING AND LAST ROW OF SIDING FRONT AND BACK.)
 - EXTERIOR LIGHT FIXTURES.
 - ANY PANELIZED PARTS FOR 2ND FLOOR CONST. OR FIELD APPLIED ROOF SYSTEM. (IE: CAPES, GAMBRELS, ETC)
 - KNEEWALL SIDING, WINDOW SHUTTERS, ON SPLIT ENTRY MODELS ARE AVAILABLE AT EXTRA COST.
 - RIDGE VENTILATION AND SHINGLES LEFT OUT AT ROOF HINGE LOCATIONS ARE SUPPLIED AND INSTALLED BY CUSTOMIZED STRUCTURES CREW.
 - STANDARD EAVE SOFFIT IS 3/8" AC PLYWOOD WITH ALUMINUM VENT STRIP TO PROVIDE ATTIC VENTILLATION ALONG WITH RIDGE VENT.
 - 15# FELT INSTALLED AT CORNERS OF HOUSE AND AROUND ALL OPENINGS FOR ALL SIDING APPLICATIONS. AIR INFILTRATION BARRIER INSTALLED UNDER CEDAR SHINGLES AND CLAPBOARDS.
 - MODULE WIDTHS ARE AVAILABLE IN 12', 13' AND 14'.
 - 12' WIDE-2x8 FLOOR JOISTS, 16" O.C.
 - 13' & 14' WIDE-2x10 FLOOR JOISTS, 16" O.C.
 - MODULES AVAILABLE IN ANY LENGTH UP TO 60'0".
- NOTE: REFER TO CUSTOMIZED STRUCTURES FIELD INSTALLATION MANUAL FOR SPECIFIC DETAILS OF FIELD FINISH AND RESPONSIBILITY.

SHEET TITLE:
Elevations

2716" x 50 Custom Two Story - Joseph General #043796 (H061036) Plan#6 ROSS

DRAWN BY: JEL

DATE: 01-09-2003

SHEET#: 1

SCALE: 3/16" = 1'0"

DWG #: _____

DLR APPRY: _____

DATE: _____

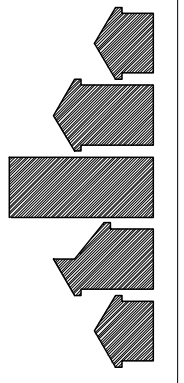

CUSTOMIZED STRUCTURES INC.
 P.O. BOX 884
 CLAREMONT, NH 03743 TEL. 603-543-1236

DATE	REVISIONS	BY	APPY
08-15-03	chgs rec'd 08-12-2003		
11-25-03	chgs rec'd 11-13-2003		
04-20-04	chgs rec'd 03-30-2004		
08-23-04	chgs rec'd 08-11-2004		
08-09-04	chgs rec'd 08-31-2004		

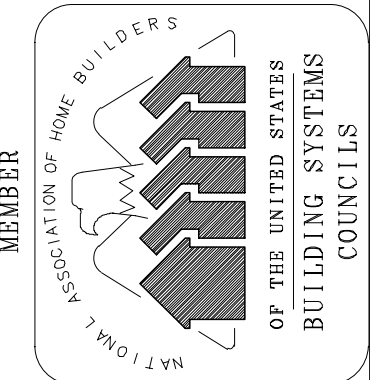
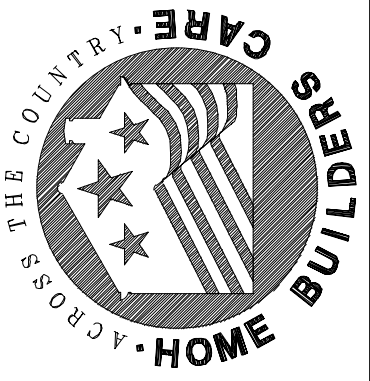

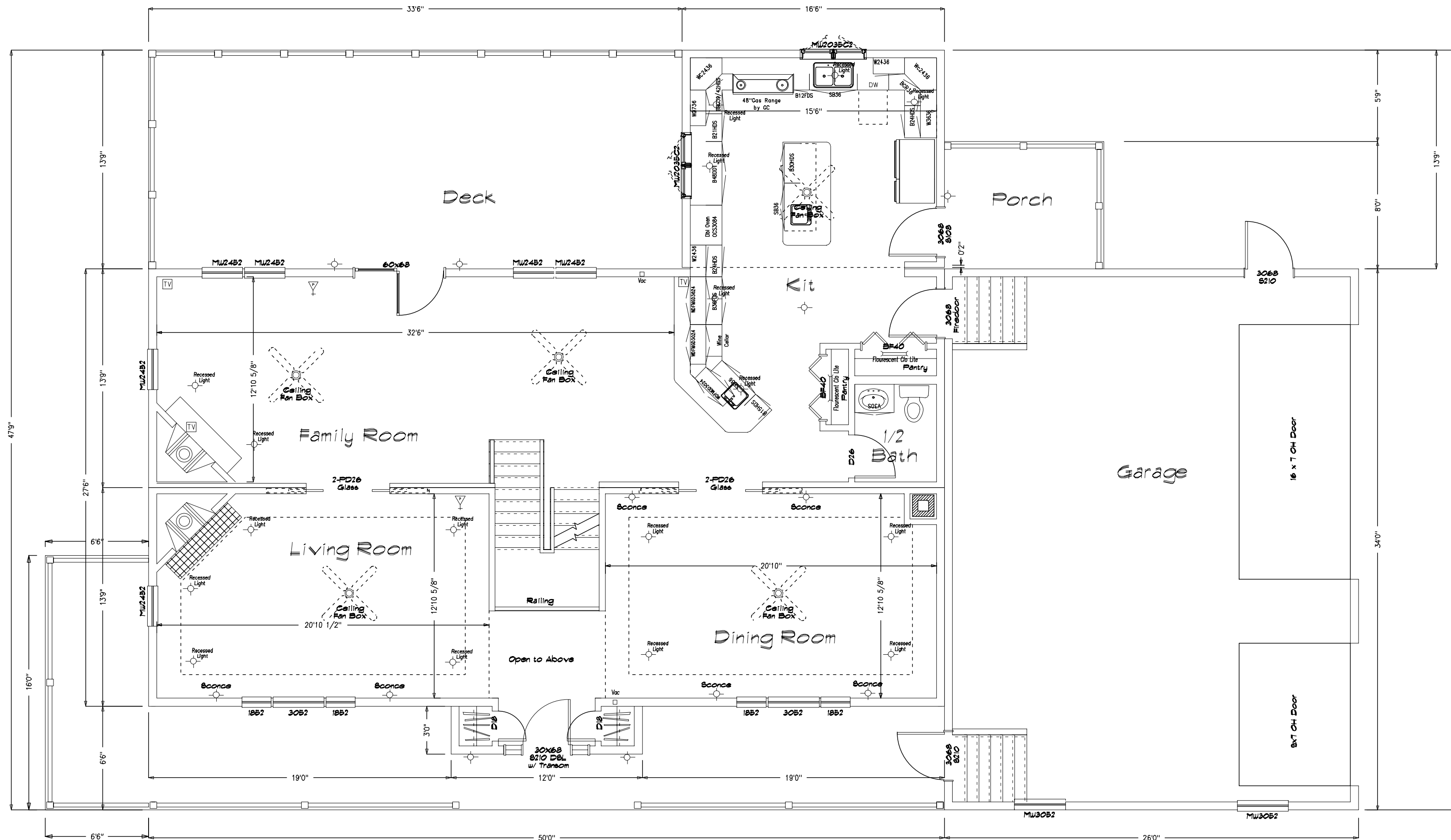

Preliminary Plan
Not for Construction use

Note: These plans represent the closest approximation to the submitted design allowing for established building codes, safety standards and design limitations.

Please make all revisions to plans in RED pen or pencil and sign and date each page. Then return to CSI for corrections.

If no revisions are desired, sign and date each page (signifying Final Approval) & Return to CSI

CERTIFICATION	
△	= STATE/THIRD PARTY & DATA PLATE
ST	= STATE LABEL
PFS	= THIRD PARTY LABEL
DP	= DATA PLATE
EGRESS WINDOW SILL HEIGHT LESS THAN OR EQUAL TO 44" ABOVE FINISH FLOOR.	

WINDOW SCHEDULE

DOOR SCHEDULE

LIGHT & VENT

SHEET TITLE:
First Floor Plan
276" x 50 Custom Two Story - Joseph General
#043796 (#R0617035) Plan#6 Ross

DRAWN BY: JEL
DATE: 01-09-2003

SHEET#: 2

SCALE: 3/16"=1'-0"

DLR APPRY: _____
DATE: _____

CUSTOMIZED STRUCTURES INC.

P.O. BOX 884
CLAREMONT, NH 03743 TEL. 603-543-1236

DATE	REVISIONS	BY	APPR
08-15-03	chgs rec'd 08-12-2003		
11-25-03	chgs rec'd 11-13-2003		
04-20-04	chgs rec'd 03-30-2004		
08-23-04	chgs rec'd 08-11-2004		
09-09-04	chgs rec'd 08-31-2004		

MEMBER
NATIONAL ASSOCIATION OF HOME BUILDERS
OF THE UNITED STATES
BUILDING SYSTEMS COUNCILS

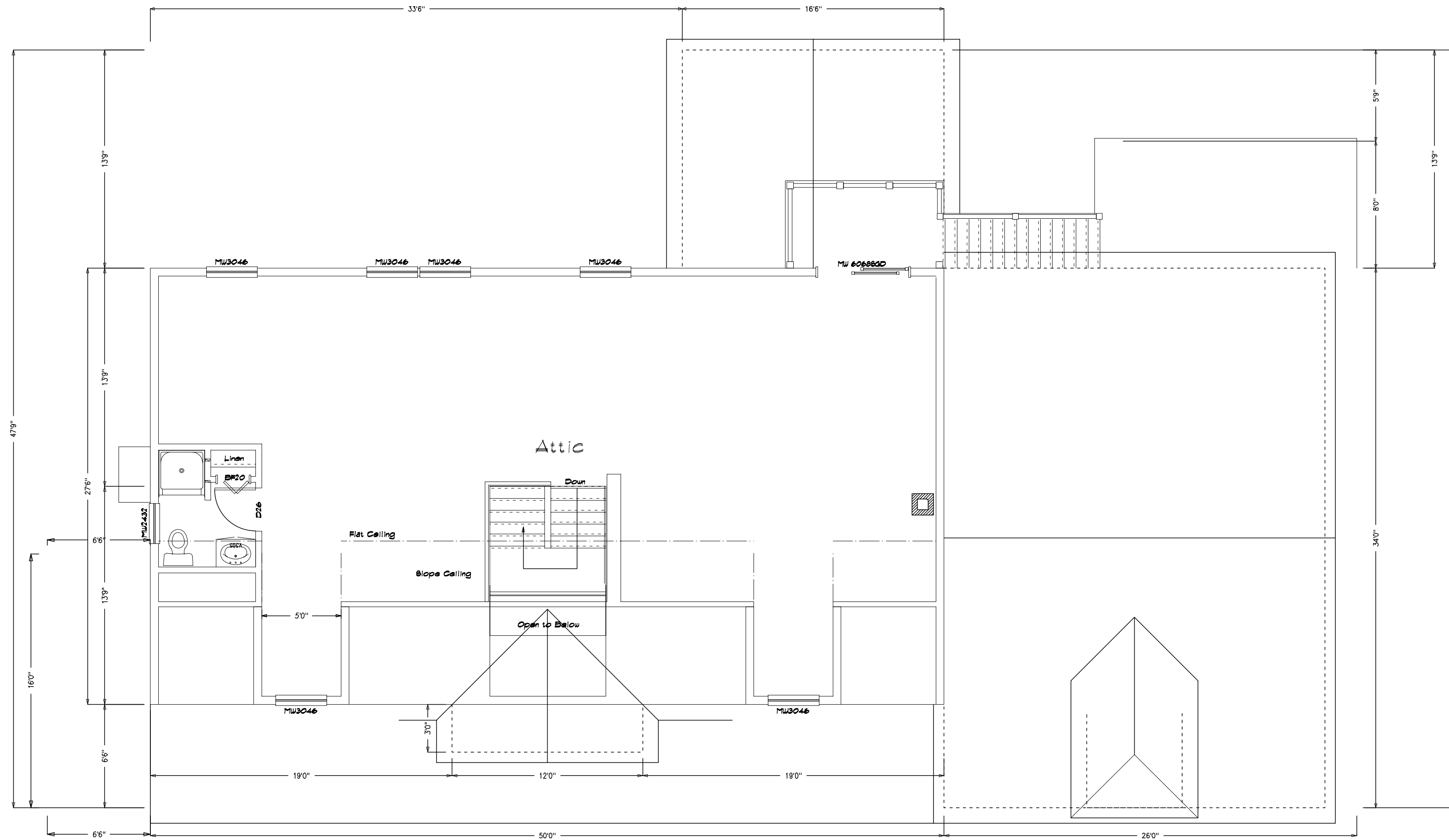

Note: These plans represent the closest approximation to the submitted design allowing for established building codes, safety standards and design limitations.

Please make all revisions to plans in RED pen or pencil and sign and date each page. Then return to CSI for corrections.

If no revisions are desired, sign and date each page (signifying Final Approval) & Return to CSI

Preliminary Plan
Not for Construction use

SHEET TITLE:
Attic Floor Plan
2716" x 50 Custom Two Story - Joseph General #043796 (#R061703b) Plan#6 Ross

DRAWN BY: JEL
DATE: 01-09-2003

SCALE: 3/16"=1'0"
DWG #:

SHEET #: 20

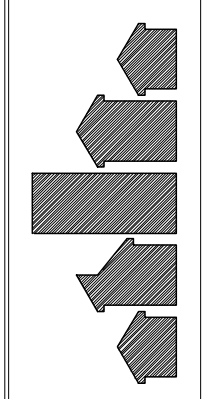

CUSTOMIZED STRUCTURES INC.
P.O. BOX 884
CLAREMONT, NH 03743 TEL. 603-543-1236

DATE	REVISIONS	BY	APPY
08-15-03	chg rec'd 08-12-2003		
11-25-03	chg rec'd 11-13-2003		
04-20-04	chg rec'd 03-30-2004		
08-23-04	chg rec'd 08-11-2004		
09-09-04	chg rec'd 08-31-2004		

