

Note: These plans represent the closest approximation to the submitted design allowing for established building codes, safety standards and design limitations.

Please make all revisions to plans in RED pen or pencil and sign and date each page. Then return to CSI for corrections.

If no revisions are desired, sign and date each page (signifying Final Approval) & Return to CSI

Preliminary Plan
Not for Construction use

NOTE:

Garages, Decks, Railings, Exterior Stairs are all optional for all homes.
Window Shutters - Optional on all Homes
Overhead Doors - Not Available from CSI
Window Grills - Optional
Kneewall Window & Siding Packages are optional (Split Level, Tri Level)
All kneewall framing & sheathing by GC
Gable End Overhangs - Optional on all Style Homes



Front Elevation
Scale: 3/16" = 1'0"

SIDING SCHEDULE

SIDING	EXPO/TYPE	CORNERS	TRIM	REMARKS
VINYL	8" HOR (4" DBL)	VINYL	VINYL/PINE	(STD)
*CEDAR	SHINGLES 5" EXP	PINE BDS	PINE/HRDBD	(OPT)
*CEDAR	CLAPBDS 4 1/2" EXP	PINE BDS	PINE/HRDBD	(OPT)
*R/R	T-III VERTICAL	PINE BDS	PINE/HRDBD	REQUIRES DRIP CAP (OPT)

*WOOD SIDINGS REQUIRE FIELD SEALING OR STAINING

NOTES

1. REFER TO INDEX SHEET TO LOCATE SPECIFIC INFO NOT COVERED ON THIS SHEET.
 2. ELEVATIONS AS REPRESENTED MAY NOT BE SPECIFIC TO MODEL OR SPECIFICATION GRADE ORDERED.
 3. THE FOLLOWING ITEMS TO BE SUPPLIED BY FIELD CONTRACTOR AND ARE SUBJECT TO LOCAL INSPECTION.
 - A. EXCAVATION, FOUNDATION WORK, SILL PLATE, LALLY COLUMNS AND SILL SEAL.
 - B. EXTERIOR STAIRS WITH MAX RISE OF 7 1/2" AND MIN. TREAD OF 11" (NOSE TO NOSE)
 - C. EXTERIOR RAILINGS WHERE REQUIRED.
 - D. DOWNSPOUTS AND GUTTERS WHERE REQUIRED.
 4. THE FOLLOWING ITEMS ARE SUPPLIED BY CUSTOMIZED STRUCTURES INC. AND INSTALLED BY FIELD CONTRACTOR (SUBJECT TO LOCAL INSPECTION)
 - A. BALANCE OF SIDING NOT INSTALLED AT FACTORY. (NORMALLY ALL GABLE END SIDING AND LAST ROW OF SIDING FRONT AND BACK.)
 - B. EXTERIOR LIGHT FIXTURES.
 - C. ANY PANELIZED PARTS FOR 2ND FLOOR CONST. OR FIELD APPLIED ROOF SYSTEM. (IE: CAPES, GAMBRELS ETC)
 - D. KNEEWALL SIDING, WINDOWS, SHUTTERS, ON SPLIT ENTRY MODELS ARE AVAILABLE AT EXTRA COST.
- NOTE: REFER TO CUSTOMIZED STRUCTURES FIELD INSTALLATION MANUAL FOR SPECIFIC DETAILS OF FIELD FINISH AND RESPONSIBILITY.

5. RIDGE VENTILATION AND SHINGLES LEFT OUT AT ROOF HINGE LOCATIONS ARE SUPPLIED AND INSTALLED BY CUSTOMIZED STRUCTURES CREWS.
6. STANDARD EAVE SOFFIT IS 3/8" AC PLYWOOD WITH ALUMINUM VENT STRIP TO PROVIDE ATTIC VENTILATION ALONG WITH RIDGE VENT.
7. 15# FELT INSTALLED AT CORNERS OF HOUSE AND AROUND ALL OPENINGS FOR ALL SIDING APPLICATIONS. AIR INFILTRATION BARRIER INSTALLED UNDER CEDAR SHINGLES AND CLAPBOARDS.
8. MODULE WIDTHS ARE AVAILABLE IN 12'13' AND 14'.
 - A. 12" WIDE-2x8 FLOOR JOISTS, 16" O.C.
 - B. 13' & 14' WIDE- 2x10 FLOOR JOISTS, 16" O.C.
9. MODULES AVAILABLE IN ANY LENGTH UP TO 60'0".

SHEET TITLE: Elevations
 27'6" x 50' Custom Tray - Hillstar Assoc
 #043128 Plans#2 Cooper
DRAWN BY: JSL
DATE: 01-23-2004
SHEET#: 1
SCALE: 3/16"=1'0"
DWG #:
DLR APPRV:
DATE:

CUSTOMIZED STRUCTURES INC.
 P.O. BOX 884
 CLAREMONT, NH 03743
 TEL. 603-543-1236

DATE	REVISIONS	BY	APPV
3-12-03	chgs rec'd 2-24-2004		

THE COUNTRY CARE HOME BUILDERS ASSOCIATION OF THE UNITED STATES BUILDING SYSTEMS COUNCILS
 MEMBER

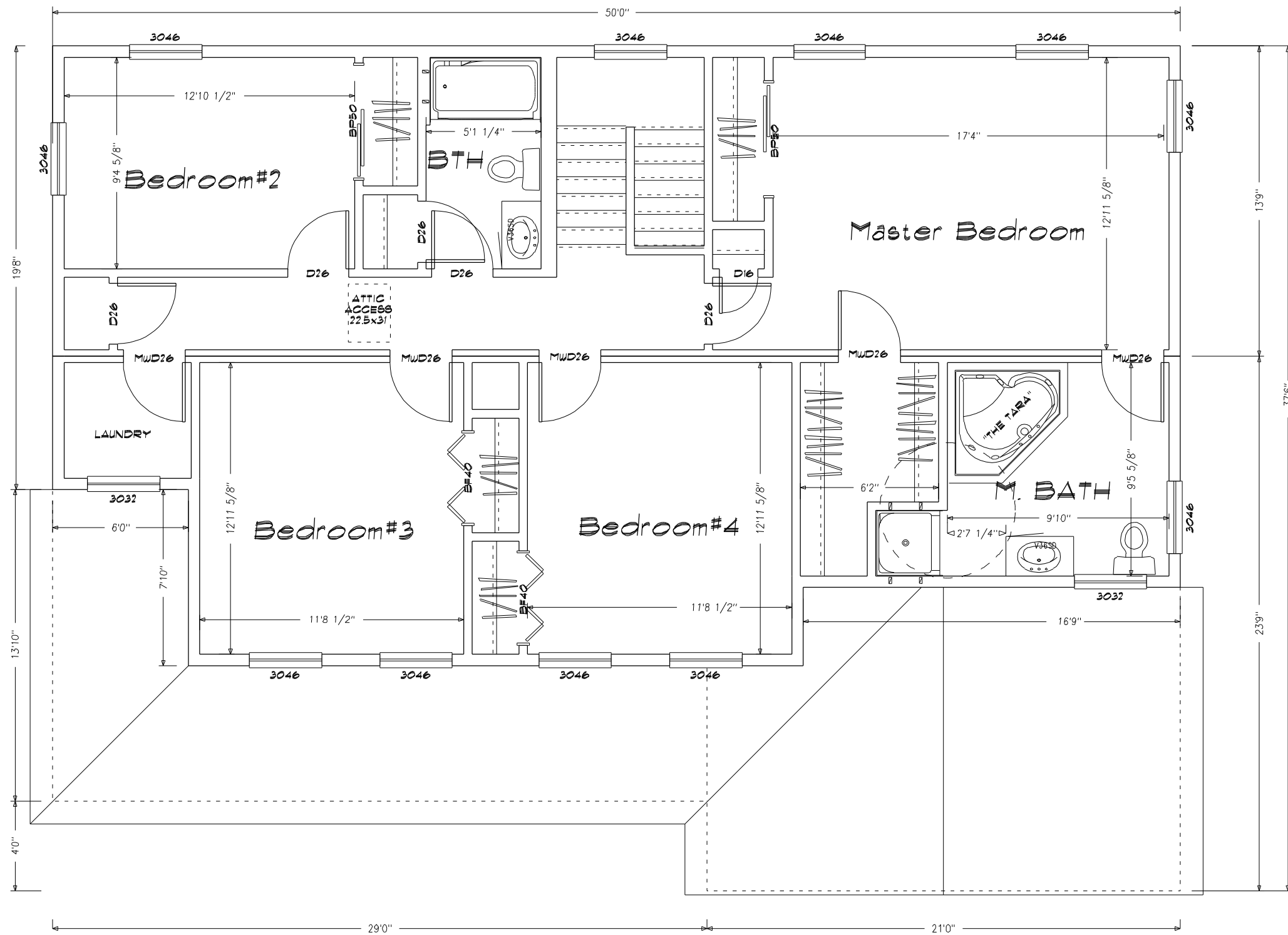

Note: These plans represent the closest approximation to the submitted design allowing for established building codes, safety standards and design limitations.

Please make all revisions to plans in RED pen or pencil and sign and date each page. Then return to CSI for corrections.

If no revisions are desired, sign and date each page (signifying Final Approval) & Return to CSI

Preliminary Plan
Not for Construction use

SHEET TITLE:
 Second Floor Plan
 27'6" x 50' Custom Tray - Hillier Assoc
 #043128 Plans#2 Copper

DRAWN BY: JSL
DATE: 01-23-2004

SCALE:
 3/16"=1'0"

DWG #:
 20.

CUSTOMIZED STRUCTURES INC.

P.O. BOX 884
 CLAREMONT, NH 03743
 TEL. 603-543-1236

DATE	REVISIONS	BY	APPY
3-12-03	chgs rec'd 2-24-2004		

